

THIS DRAWING IS UNPUBLISHED. RELEASED FOR PUBLICATION
 © COPYRIGHT - By - ALL RIGHTS RESERVED.

LOC		DIST		REVISIONS			
P	LTR	DESCRIPTION		DATE	DWN	APVD	
AA	22	A1	REVISED PER ECO-11-005033		29MAR11	RK	HMR

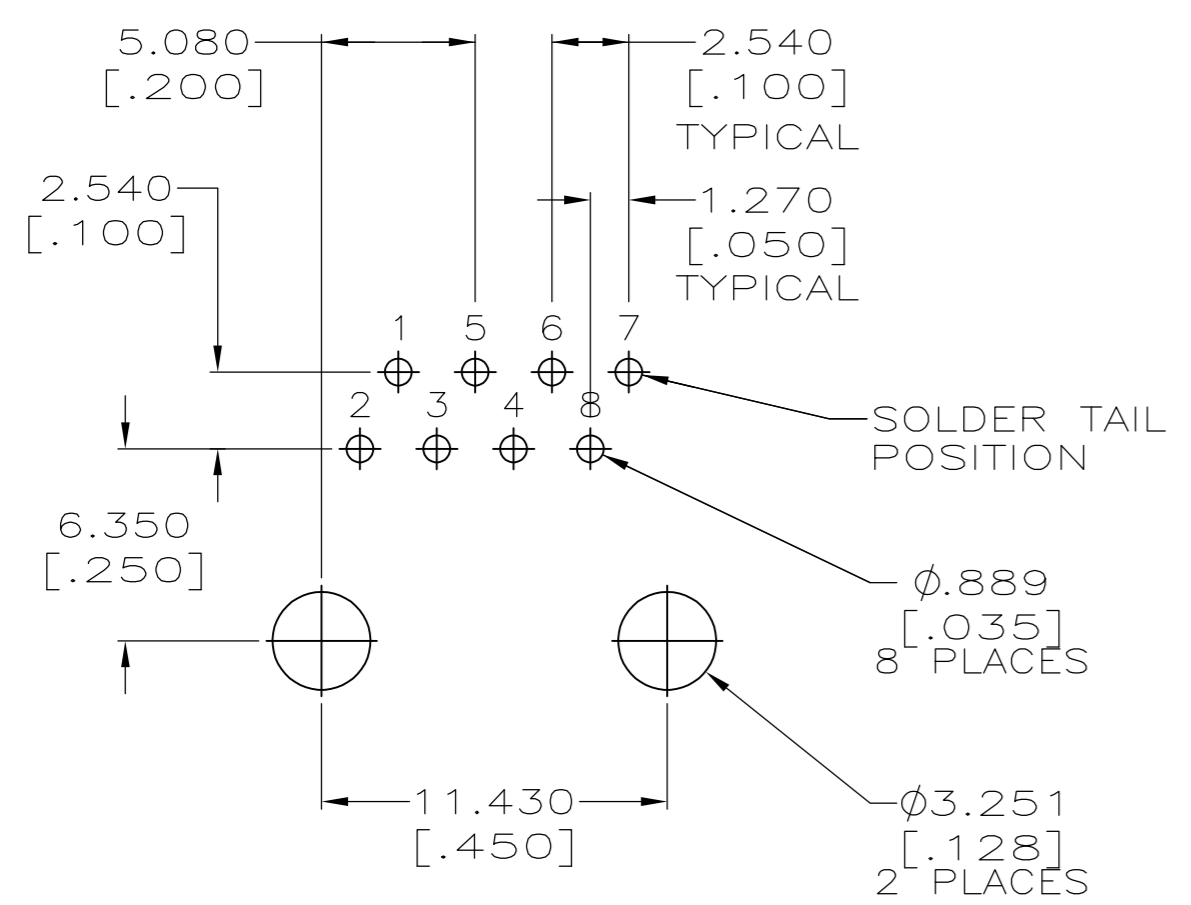

SUGGESTED PC BOARD LAYOUT
COMPONENT SIDE

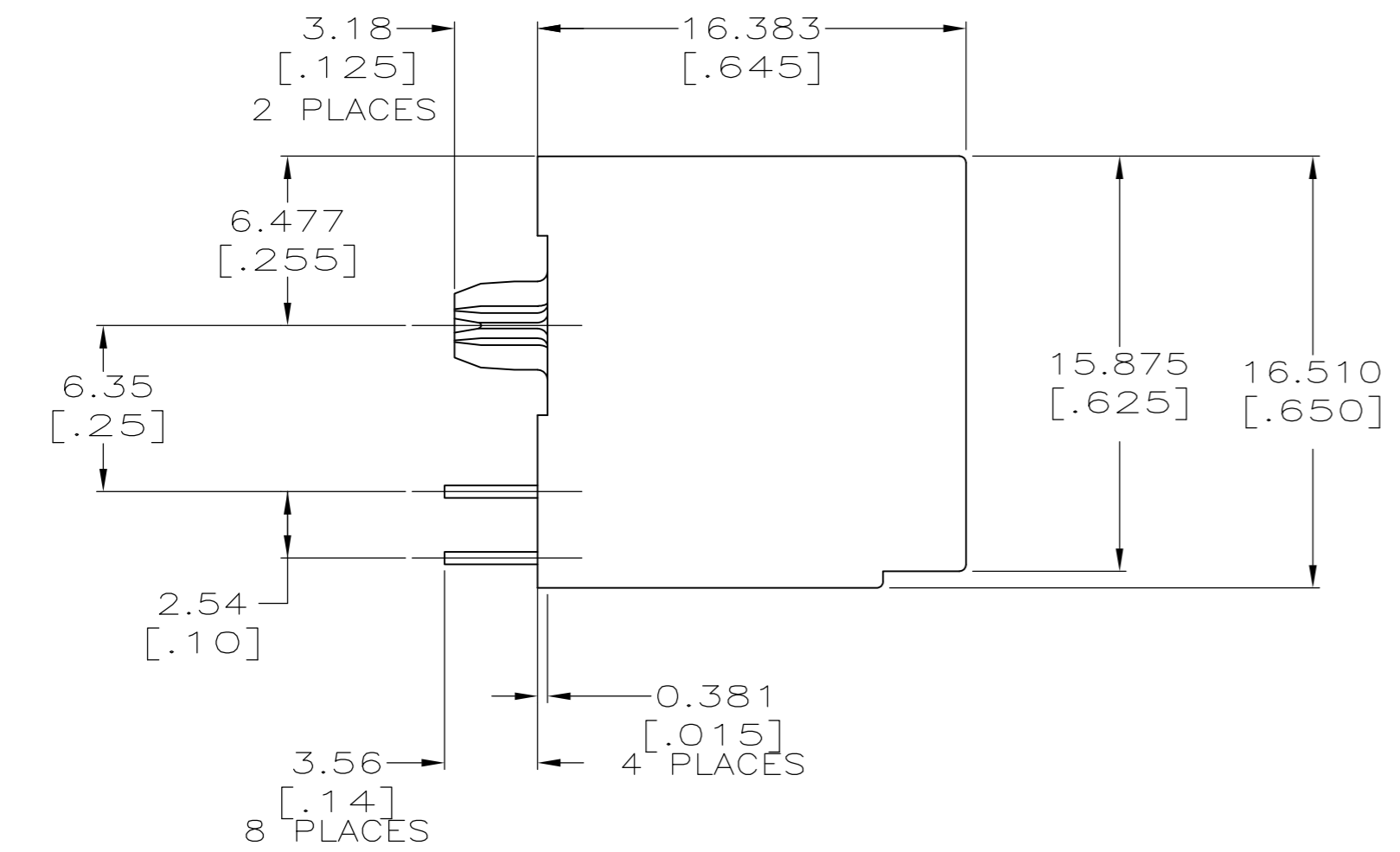
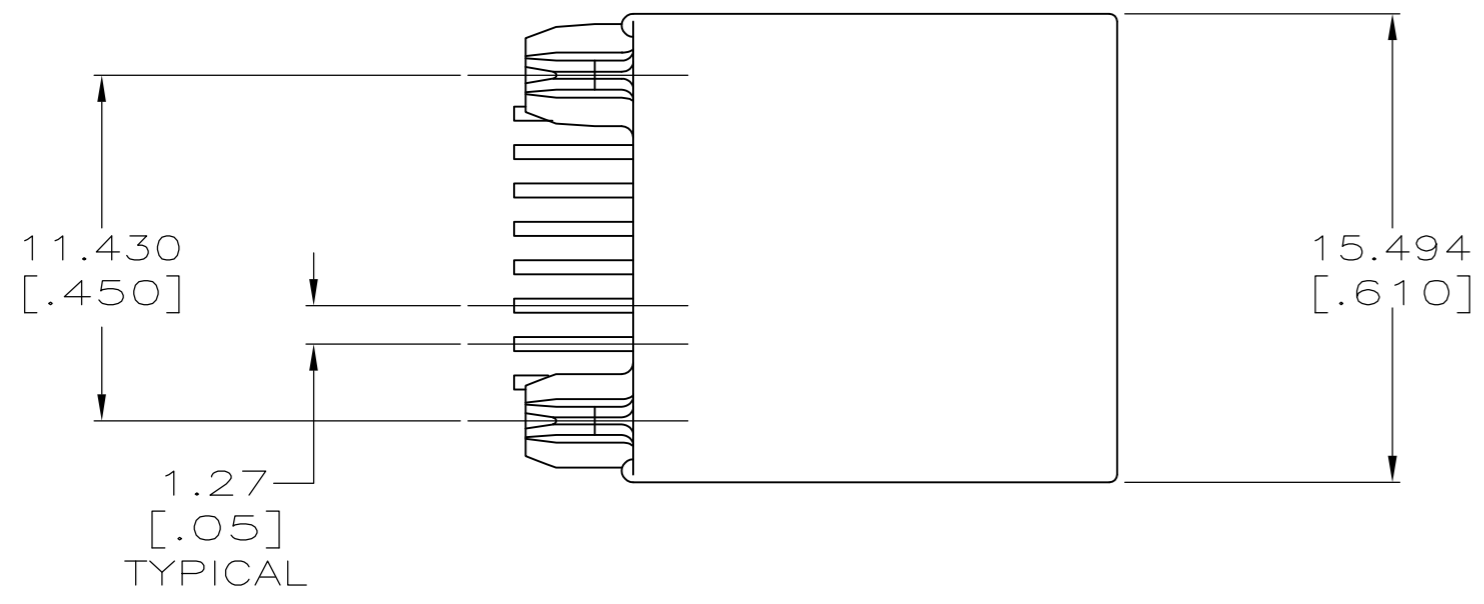
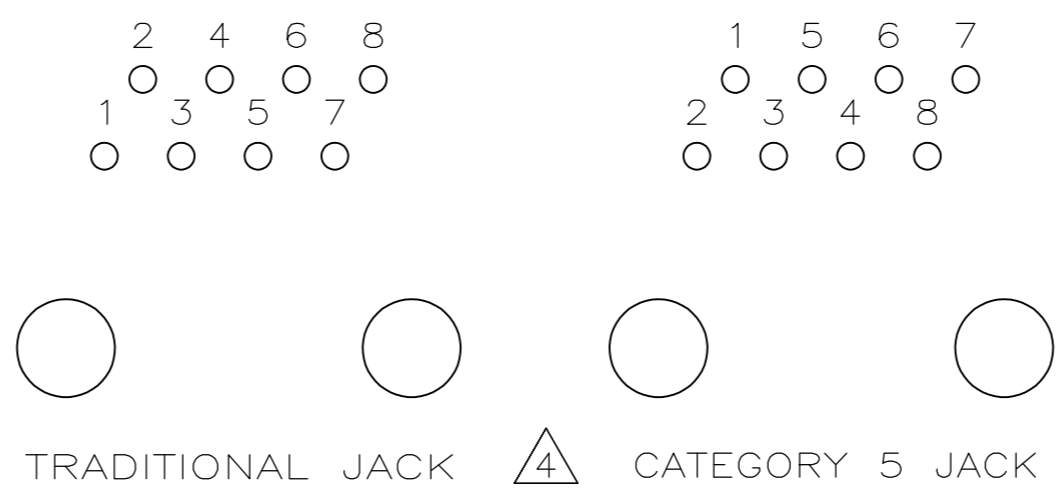
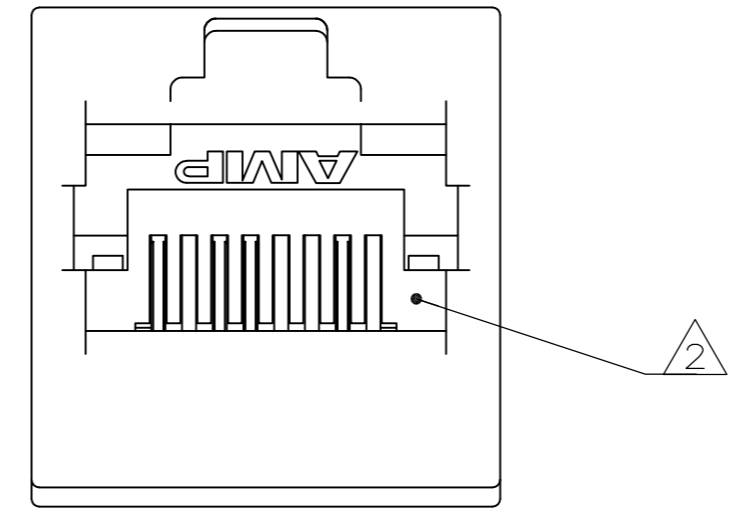

- 1 MATERIAL: HOUSING - POLYESTER MOLDING COMPOUND, BLACK, UL 94V-0.
TERMINALS - 0.33[.013] THICK PHOS BRONZE PLATED WITH 1.27µm[.000050] MINIMUM THICK HARD GOLD IN LOCALIZED AREA AND 3.81µm[.000150] MINIMUM THICK MATTE TIN IN SOLDER AREA OVER 1.27µm[.000050] MINIMUM THICK NICKEL UNDERPLATE.
TERMINAL INSERT PLASTIC: POLYESTER MOLDING COMPOUND, GRAY, UL 94V-0.
- 2 JACK CAVITY CONFORMS TO FCC RULES AND REGULATIONS, PART 68 SUBPART F.
- 3 ALL DIMENSIONS SHOWN ARE NOMINAL UNLESS OTHERWISE SPECIFIED.
- 4 CAUTION: CATEGORY 5 JACK SOLDER TAIL POSITIONS DO NOT FOLLOW SAME NUMBER SEQUENCE AS THAT OF TRADITIONAL JACKS.

5558397-1
PART NO.

THIS DRAWING IS A CONTROLLED DOCUMENT.		DWN	R.GRZYBOWSKI	09NOV05	STE TE Connectivity				
DIMENSIONS: mm		CHK	J.WESTMAN	09NOV05					
TOLERANCES UNLESS OTHERWISE SPECIFIED:		APVD	S.FLICKINGER	09NOV05	NAME				
0 PLC ± -	1 PLC ± -	PRODUCT SPEC		108-1163					
2 PLC ± 0.25[.01]	3 PLC ± 0.127[.005]	APPLICATION SPEC		114-2048					
4 PLC ± -	ANGLES ± -	MATERIAL		WEIGHT		SIZE	CAGE CODE	DRAWING NO	RESTRICTED TO
FINISH		MATERIAL		WEIGHT		A2	00779	C=5558397	-
CUSTOMER DRAWING		SCALE		SHEET		REV		A1	
		4:1		1 of 1					